

ABOUT SHIFTED

Shifted occupies an ambiguous space. It provides a platform for the creation, exhibition and critical development of new and contemporary art, however it shifts and repositions itself between established art space models.

At once a studio complex, an artist-run initiative and a commercial gallery, Shifted allows these typically separated sites to overlap, merge and collide, informing and impacting on one another, and making space for the cross-fertilisation of ideas and forms.

THE SPECS.

Shifted is located in one of Melbourne’s most densely populated gallery districts at Level 1, 15 Albert Street Richmond.

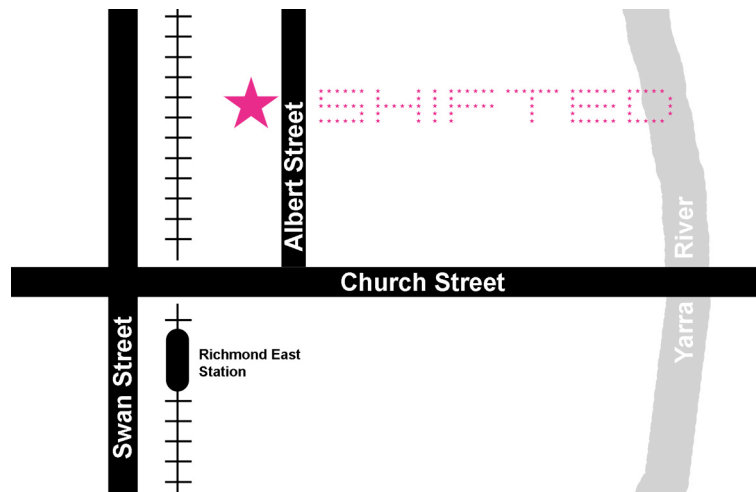

Shifted’s exhibition space comprises three purpose-built galleries: Gallery 1, Gallery 2 and Grey Area. Proposals are invited for Gallery 1 and Gallery 2.

Gallery 1 is an open space approximately 6 meters wide by 10 meters deep with a sealed concrete floor. Gallery 2 is a more intimate space at approximately 3 meters wide by 6.5 meters deep with a painted vinyl floor. Both spaces have ceilings of approximately 2.7 meters in height that support gallery-quality adjustable track lighting systems.

Exhibitions in both of these spaces typically run for a period of 3 weeks.

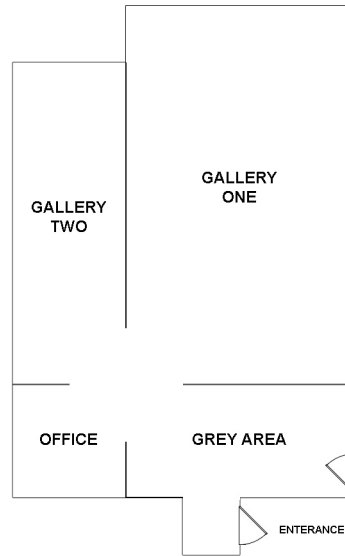

WHO CAN APPLY

Proposals are accepted by Shifted on an ongoing basis centered around annual deadlines for specific exhibition periods.

Shifted recognises and supports the diversity that exists across contemporary visual arts practices. Applications are consequently accepted from emerging and established artists and curators working professionally in any visual arts medium. Proposals for individual, group and curated exhibitions are welcome, as well as performances, launches and forums.

Shifted programs its calendar with a view to present an engaging and diverse program of high-quality events across a range of media and critical approaches.

WHAT TO INCLUDE IN YOUR PROPOSAL

Proposal Cover Sheet

Please provide a cover sheet including the exhibitor's name and contact details, the preferred exhibition space and the preferred timing of the exhibition. If a group show is being proposed, please nominate one exhibitor as a contact person together with a list of all other applicants. All cover sheets should also include a brief summary of the proposal (no more than 2 to 3 sentences), as well as an indication of whether the proposed exhibition contains audio or any other elements that might impact on the exhibition in the adjoining space.

A template for the Proposal Cover Sheet is attached at the end of this document. This may be completed and submitted with your proposal.

A Typed Description of Proposed Exhibition

(no more than one A4 page)

Please provide a clear and concise description of the work you wish to exhibit and the ideas that inform this. It should be kept brief as possible, use clear subheadings where appropriate, and describe if the work is suited to a particular exhibition space.

Proposals for group shows or collaborations should clearly demonstrate the rationale linking the exhibitors.

If there is a conceptual or visual gap between your proposal and support material, please describe how this new body of work will be realised and how it relates to your past work.

Curriculum Vitae

(no more than one A4 page per exhibitor)

Please provide a Curriculum Vitae outlining previous experience relative to your arts practice including previous exhibitions, studies, publications, etc.

Visual Support Material

A maximum of 10 images should be submitted for a solo exhibition and 20 for a group exhibition. These may be submitted as slides or digital images however CDs and DVDs are the preferred format for visual material.

All slides must be marked clearly with the artist's name, and the title, date, dimensions and medium of the work. These details should also be listed in a one-page description of the support material.

Digital images should be provided in jpeg format on CD.

Audiovisual material should be provided on DVD or CD where possible however VHS may also be provided where necessary. A/V material should not exceed 6 minutes in duration.

A select amount of additional support material such as past publications, invitations and exhibition reviews may also be provided.

DO NOT SEND ORIGINALS. Please remember to include a sufficient sized postage paid envelope for the return of your visual support material.

Description of Visual Support Material

This page should consist of a list that corresponds to the visual material provided. For each item of visual support material submitted please provide the artist's name, the title of the work, its date, dimensions and medium. Please also indicate whether the images provided show work that is intended for the proposed exhibition.

Shifted retains all successful and unsuccessful written material from applications for its archives. Images from all successful applications are also retained until the time of the exhibition.

HOW TO APPLY

Postal applications are the preferred method of delivery. Emailed or faxed applications will not be accepted, however applications may also be submitted to the gallery in person.

Applications should be typed with the name of the exhibitor included on all pages of the proposal.

INFORMATION FOR SUCCESSFUL APPLICANTS

Successful applicants will be sent additional information outlining what happens next. Each successful applicant will be required to sign an exhibitor's agreement and pay a 50% deposit upon accepting the exhibition space they have been offered. The balance will be payable two weeks prior to the commencement of the exhibition.

Shifted will provide staffing of the gallery for the duration of the exhibition and will also provide guidance and assistance with the installation of exhibitions where they deem it is appropriate or necessary. While Shifted recognises that the manner in which an exhibition is installed can be as important to the reception of the work as the work itself, Shifted reserves the right to make decisions and have final input with regard to the way in which an exhibition is installed. This is simply to ensure that a professional standard is maintained and such input should rarely be required.

WHAT ARE THE COSTS

Gallery 1: \$860 per 3 week show

Gallery 2: \$560 per 3 week show

In addition to staffing exhibitions, Shifted will normally design and print invitations for the exhibition (a number of which will be provided to the exhibitor for their own distribution); design and distribute an electronic invitation; list the exhibition in the Art Almanac; provide coverage of the exhibition on the Shifted website (www.shifted.net.au); organise and facilitate the opening for the exhibition (typically held on Wednesday nights from 6:00 to 8:00); and facilitate the sale of any works as may be required.

Exhibitors are responsible for the insurance of their own work and equipment if required.

DEADLINES

Check the website for current deadlines: www.shifted.net.au

Please post proposals to:

Shifted
PO Box 4241, East Richmond VIC 3121

PROPOSAL COVER SHEET

Exhibition Title:

Exhibitor's Name:
(or primary contact for group or curated exhibitions)

Address:
.....

Phone Numbers:

BH: AH: M:

Email:

Names of additional exhibitors (if applicable):
.....
.....

Preferred Gallery: Gallery1 Gallery 2 Gallery 1 & 2 Other

Preferred Timing of Exhibition:

Proposal Summary:
.....
.....
.....
.....
.....
.....
.....
.....

Does the proposed exhibition contain audio or any other element that might impact on an exhibition in the adjoining gallery?

.....